

Philips 8500 series
4K UHD LED Android TV
with Ambilight 3-sided

178 cm (70") Ambilight TV

Major HDR formats supported
P5 Perfect Picture Engine
Android TV / AI voice control



70PUS8505

Performance Series: The one to watch

4K UHD LED Android TV

This is the one you are looking for. Superb picture quality. Elegant design. Great sound. AI voice control. Ambilight for an immersive experience like no other. Everything you need to enjoy movie night, sports, or a weekend gaming marathon

Slim TV. Beautiful light.

- Philips 4K UHD TV. Vibrant HDR picture.
- Silver metal bezel. Height adjustable feet.
- The magic of Ambilight. Only from Philips.

Smooth motion. Real color. Incredible depth.

- Philips P5 Engine. Whatever the source, always perfection.
- HDR10+ supported. See more of what the director intended.
- Dolby Vision and Dolby Atmos. Cinematic vision and sound.
- Stand height adjusts to accommodate a soundbar.
- Well-balanced audio. Crisp, clear dialogue. Punchy effects.

Android TV-content at your command

- Voice control. Google Assistant built-in. Works with Alexa.
- Android TV. Simply smart.
- DTS Play-Fi. Multi-room audio.

PHILIPS

4K UHD LED Android TV

178 cm (70") Ambilight TV Major HDR formats supported, P5 Perfect Picture Engine, Android TV / AI voice control

Highlights

Ambilight 3-sided



With Philips Ambilight every moment feels closer. Intelligent LEDs around the edge of the TV respond to the on-screen action and emit an immersive glow that's simply captivating. Experience it once and wonder how you enjoyed TV without it.

Dolby Vision and Dolby Atmos

Support for Dolby's premium sound and video formats means the HDR content you watch will look-and sound-gloriously real. Whether it's the latest streaming series or a Blu-Ray disc set, you'll enjoy contrast, brightness, and color that reflect the director's original intentions. And hear spacious sound with clarity, detail, and depth.

Android TV.



Make your Philips Android TV your own. If it's all about Amazon and YouTube this week, and Rakuten TV and Netflix next week-no problem. A clear, intuitive interface lets you put the content you love front and center. Easily pick up where you left off in the latest series, or check out the new movie releases.

P5 Perfect Picture Engine

The Philips P5 engine delivers a picture as brilliant as the content you love. Details have noticeably more depth. Colors are vivid, while skin tones look natural. Contrast is so crisp you'll feel every detail. Motion is perfectly smooth.

4K UHD HDR



Your Philips 4K UHD TV is compatible with all major HDR formats, including HDR10+ and

70PUS8505/12

Dolby Vision. Whether it's a must-watch series or the latest video game, shadows will be deeper. Bright surfaces will shine. Colors will be truer.

Voice assistant

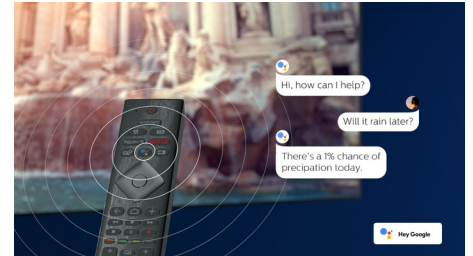

Control your Philips Android TV with your voice. Want to play a game, watch Netflix, or find content and apps in the Google Play store? Just tell your TV. You can even command all Google Assistant-compatible smart home devices, like dimming the lights and setting the thermostat on movie night. Without leaving the sofa. The days of searching for the TV remote are over. Now you can use your voice to control your Philips smart TV via Alexa-enabled devices, like Amazon Echo. Turn your TV on, change the channel, switch to your gaming console and more with Alexa.

HDR10+ supported

Your Philips TV is primed to get the most out of the HDR10+ video format. Contrast, color, and brightness levels are adjusted from frame to frame. Whether it's a must-watch series or the new blockbuster, shadows will be deeper. Bright surfaces will shine. Colors will be truer.



4K UHD LED Android TV

178 cm (70") Ambilight TV Major HDR formats supported, P5 Perfect Picture Engine, Android TV / AI voice control

Specifications

Ambilight

- Ambilight Version: 3-sided
- Ambilight Features: Built in Ambilight+hue, Ambilight Music, Game Mode, Wall colour adaptive, Lounge mode, AmbiWakeUp, AmbiSleep

Picture/Display

- Display: 4K Ultra HD LED
- Diagonal screen size: 70 inch / 178 cm
- Panel resolution: 3840x2160
- Aspect ratio: 16:9
- Pixel engine: P5 Perfect Picture Engine
- Picture enhancement: Ultra Resolution, Dolby Vision, HDR10+, 2100 PPI

Supported Display Resolution

- Computer inputs on all HDMI: HDR supported, HDR10/ HLG, up to 4K UHD 3840x2160 @60Hz
- Video inputs on all HDMI: up to 4K UHD 3840x2160 @60Hz, HDR supported, HDR10/ HLG (Hybrid Log Gamma), HDR10+/Dolby Vision

Android TV

- OS: Android TV™ 9 (Pie)
- Pre-installed apps: Google Play Movies*, Google Play Music*, Google Search, YouTube, Netflix, Amazon instant video, BBC iplayer
- Memory size(Flash): 16GB*

Smart TV Features

- User Interaction: SimplyShare
- Interactive TV: HbbTV
- Program: Pause TV, USB recording*
- Ease of Installation: Auto detect Philips devices, Device connection wizard, Network installation wizard, Settings assistant wizard
- Ease of Use: One-stop smart menu button, Onscreen usermanual
- Firmware upgradeable: Firmware auto upgrade wizard, Firmware upgradeable via USB, Online firmware upgrade
- Screen Format Adjustments: Basic - Fill Screen, Fit to screen, Advance - Shift, Zoom, stretch, Wide screen
- Remote Control: with Voice
- Voice assistant*: Google Assistant built-in, RC with Mic., Works with Alexa

Processing

- Processing Power: Quad Core

Tuner/Reception/Transmission

- HEVC support
- Digital TV: DVB-T/T2/T2-HD/C/S/S2
- MPEG Support: MPEG2, MPEG4
- Video Playback: PAL, SECAM
- TV Program guide*: 8 day Electronic Program Guide
- Signal strength indication
- Teletext: 1000 page Hypertext

Connectivity

- Number of HDMI connections: 4
- Number of USBs: 2
- Wireless connections: Bluetooth 4.2, Wi-Fi 802.11ac, 2x2, Dual band
- Other connections: Satellite Connector, Common Interface Plus (CI+), Digital audio out (optical), Ethernet-LAN RJ-45, Headphone out, Service connector
- HDMI features: 4K, Audio Return Channel
- EasyLink (HDMI-CEC): Remote control pass-through, System audio control, System standby, One touch play
- HDCP 2.3: Yes on all HDMI

Multimedia Applications

- Video Playback Formats: Containers: AVI, MKV, H264/MPEG-4 AVC, MPEG-1, MPEG-2, MPEG-4, WMV9/VC1, VP9, HEVC (H.265)
- Subtitles Formats Support: .SRT, .SUB, .TXT, .SMI
- Music Playback Formats: AAC, MP3, WAV, WMA (v2 up to v9.2), WMA-PRO (v9 and v10)
- Picture Playback Formats: JPEG, BMP, GIF, PNG, 360 photo, HEIF

Power

- Mains power: AC 220 - 240 V 50/60Hz
- Standby power consumption: <0.3W
- Ambient temperature: 5 °C to 35 °C
- Power Saving Features: Auto switch-off timer, Light sensor, Picture mute (for radio), Eco mode
- Energy Label Class: A
- Eu Energy Label power: 137 W
- Annual energy consumption: 201 kW h
- Mercury content: 0 mg
- Presence of lead: Yes*
- Off mode power consumption: N/A W

Sound

- Output power (RMS): 20W

70PUS8505/12

- Sound Enhancement: Auto Volume Leveler, Dolby Atmos, 5 Band Equalizer, A.I. Sound, Bass Enhancement, Clear Dialogue, Night mode
- Speaker configuration: 2x10W full range speaker

Dimensions

- Box dimensions (W x H x D): 1757.0 x 1025.0 x 181.0 mm
- Set dimensions (W x H x D): 1581.0 x 894.0 x 86.1 mm
- Set dimensions with stand (W x H x D): 1581.0 x 912.4 x 312.2 mm
- Stand dimensions (W x D): 810 / 1401 x 312.2 mm
- Adjustable stand height (Max.): 81.4 mm
- Adjustable stand height (Min.): 18.4 mm
- Product weight: 27.6 kg
- Product weight (+stand): 28.2 kg
- Weight incl. Packaging: 32.7 kg
- VESA wall mount compatible: 400 x 200 mm

Design

- Colors of TV: Light silver metal bezel
- Stand design: Light silver sticks

Accessories

- Included accessories: Remote Control, Quick start guide, Legal and safety brochure, Power cord, Table top stand
- Included batteries: 2 x AAA Batteries



Connections

Side

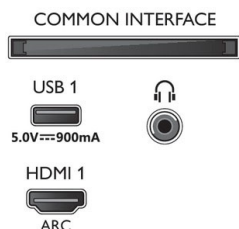

Bottom

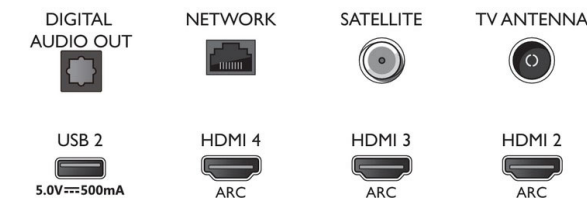

Issue date 2020-08-24

Version: 7.2.1

12 NC: 8670 001 65542
EAN: 87 18863 02299 3

© 2020 Koninklijke Philips N.V.
All Rights reserved.

Specifications are subject to change without notice.
Trademarks are the property of Koninklijke Philips N.V.
or their respective owners.

www.philips.com

* EPG and actual visibility (up to 8 days) is country and operator dependent.

* Android App offerings vary per country. For more details please visit your local Google Play Store.

* *Memory size (Flash) : 16GB, the actual available disc space may differ (dependent on e.g. (pre-)installed apps, installed operating system, etc.)

* Energy consumption in kWh per year, based on the power consumption of the television operating 4 hours per day for 365 days. The actual energy consumption will depend on how the television is used.

* The TV supports DVB reception for 'Free to air' broadcast. Specific DVB operators may not be supported. An up to date list can be found in the FAQ section of the Philips support website. For some operators Conditional Access and subscription are required. Contact your operator for more information.

* Philips TV Remote app and related functionalities vary per TV model, operator, and country, as well as smart device model and OS. For more details please visit: www.philips.com/TVRemoteapp.

* Smart TV app offerings vary per TV model and country. For more details please visit: www.philips.com/smarttv.

* USB recording for digital channels only, recordings may be limited by broadcast copy protection (CI+). Country and channel restrictions may apply.

* Please note that your Amazon Apps may not always be available in your country. (Currently Amazon apps works only in UK, Germany, Austria)

* This television contains lead only in certain parts or components where no technology alternatives exist in accordance with existing exemption clauses under the RoHS Directive.